

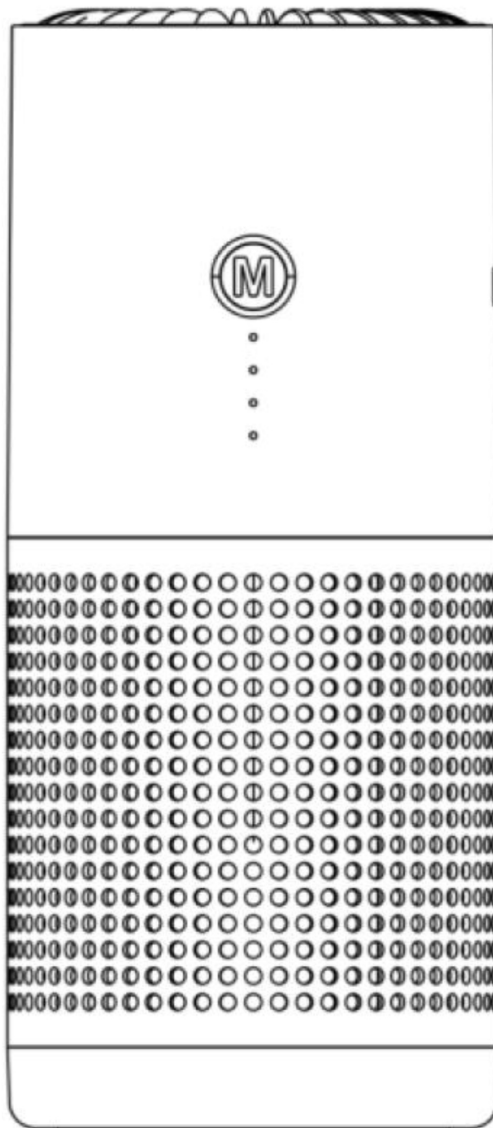

CustomerService@StandUpDeskStore.com

1-855-843-7920

## SUD-AIRPUR-SWH



## Product Specifications

- Product name: Mini HEPA and Ionic Air Purifier
- Product model: SUD-AIRPUR-SWH
- Housing materials: ABS, aluminum
- Filter type: HEPA
- Input voltage/current: DC5.0V~6.0V MAX ( $\pm 10\%$ )
- Operating current: 400~850mA
- Operating power: 4.5W
- Fan operating current/power:
  - Low: 450mA/2.25W
  - Medium: 600mA/3W
  - High: 820mA ( $\pm 10\%$ )/4.25W
- Negative ion concentration:  $8 \times 10^8$ PCS/cm<sup>3</sup> (tested at 100cm from the unit)
- PPM: <0.05PPM
- Product dimensions: 3" W x 3" D x 6.75" H
- Product weight: 0.5 lbs.
- Testing standard: GB4706.45-2008
- Place of manufacture: Shenzhen, China

## Parts Diagram

1. Air quality indicator light
2. Function button ("M")
3. Function indicator lights
  - a. High fan speed
  - b. Medium fan speed
  - c. Low fan speed
  - d. Ionic air purifier
4. Purifier mechanism
5. Filter element
6. Air intake screen
7. Base
8. USB-A power output
9. USB-C power input

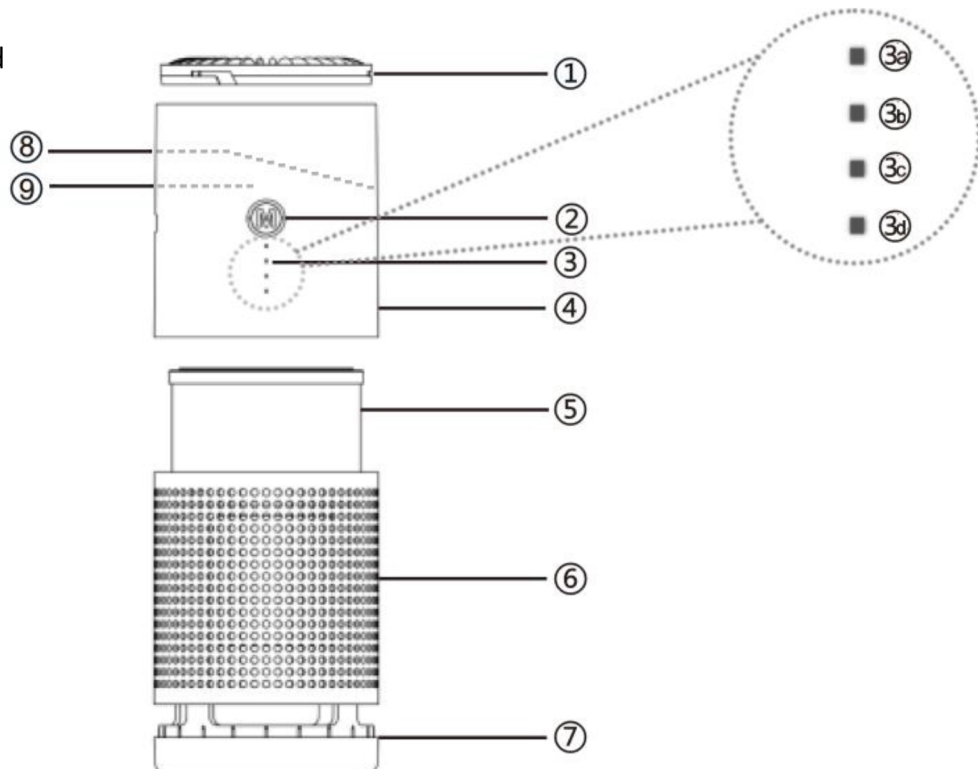

# Operating Instructions

## Powering the Unit:

1. Plug the included USB-A to USB-C cable into a suitable USB power source, such as on a computer, in a car, or an AC wall adapter.
2. Plug the other end of the cable into the USB-C power input connection located on the back of the air purifier.

## Adjusting Air Filtration Settings:

1. Click the "M" button once to turn on the device. Once powered up, the device will operate in automatic mode. In this mode, the purifier will automatically adjust fan speed based on air quality.
2. Click the "M" button a second time to activate the "Low" fan setting in manual mode.
3. Click the "M" button a third time to activate the "Medium" fan setting in manual mode.
4. Click the "M" button a fourth time to activate the "High" fan setting in manual mode.
5. Click the "M" button a fifth time to turn off the machine.

## Turning On/Off the Ionic Air Purifier:

The ionic air purifier helps address airborne contaminants too small to be trapped in an air filter. This function turns on at startup and is always activated when the machine is operating in automatic mode. When the device is set in one of the three manual mode settings, you have the option to turn the function on and off.

1. Press and hold the "M" button for two seconds to activate or deactivate the ionic air purifier.
2. When the ionic air purifier indicator light turns on or off, release the button.

## Using the USB-A Port to Power Other Devices:

The USB-A power output can provide DC5V power to other devices, for example to charge a smartphone.

1. Plug a USB-A compatible cable into the USB-A port located on the right side of the air purifier unit.
2. Plug the other end of the cable into the device you wish to power.

# Understanding the Indicator Lights

## Air Quality Indicator:

The air quality indicator light is located on top of the air purifier unit.

1. At startup, the light will cycle through its three colors (red, green, blue) and then will show green.
2. After three minutes have passed, the light will stay green or change color based on air quality:
  - Green = Good
  - Blue = Normal
  - Red = Poor

## Ionic Air Purifier Indicator:

The ionic air purifier indicator light is the lowest of the four white LEDs located on the front of the air purifier unit.

1. When the ionic air purifier is turned on, the negative ion indicator light will slowly pulse.
2. When the ionic air purifier is turned off, the light will turn off.

## Fan Speed Indicators:

The fan speed indicator lights are the top three white LEDs located on the front of the air purifier unit.

1. In automatic mode, all three indicator lights will shine.
2. In the manual mode's lowest speed setting, only the lowest of the three lights will shine.
3. In the manual mode's medium speed setting, only the middle of the three lights will shine.
4. In the manual mode's high-speed setting, only the top of the three lights will shine.

**NOTE:** When the machine is turned off, all three fan speed indicators, the ionic air purifier, and air quality indicator lights will turn off.

## Safety and Use

- Depending on air quality and amount of use, we recommend:
  - Cleaning the filter every 30 to 60 days
  - Replacing filter every three to six months
- When cleaning the filter element:
  - Do not wash it with water.
  - Use a hairdryer, soft brush, or toothbrush to gently remove dust and debris collected on the filter element.
  - Do not knock the filter element against hard objects to break loose dust and debris, as this may damage the filter.
- This filter is designed to purify the air in a 16 to 32-foot radius. If you need to purify the air in a larger area, a higher-powered purifier will be required.
- A small amount of ozone will be produced by this product when it is operating. If this affects your breathing in any way, turn off the machine and open a window for ventilation.
- Do not spray liquids onto the filter. This includes scented liquids such as perfumes, essential oils, etc.

## Filter Removal and Replacement

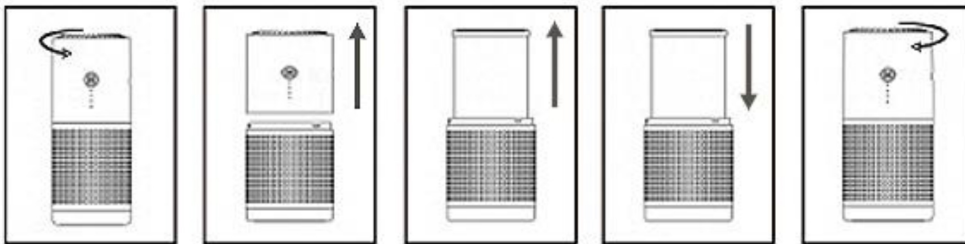

Rotate the top counterclockwise

Separate top from base

Remove filter for cleaning or replacement

Insert clean or new filter

Rotate top clockwise