

**Hardware:**



Replacement Cables



Zip Ties

**Installation Tips:**

- When uninstalling locker from wall please request assistance, it is recommended to have at least 2 people.



Allen Wrench



Wire Cutter

**Assembly:**

- 1** Unplug locker from wall. Locate and remove 6 bolts keeping the locker shell and face together. With 2 people, remove face and place on a flat large surface.

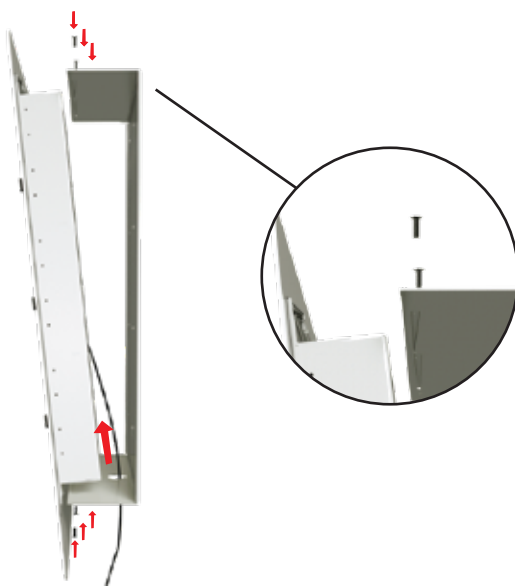

- 2** Inspect unit for obvious signs of wear and tear, any unplugged cables. Locate cables that were not working properly and snip the zip tie holding it in place.

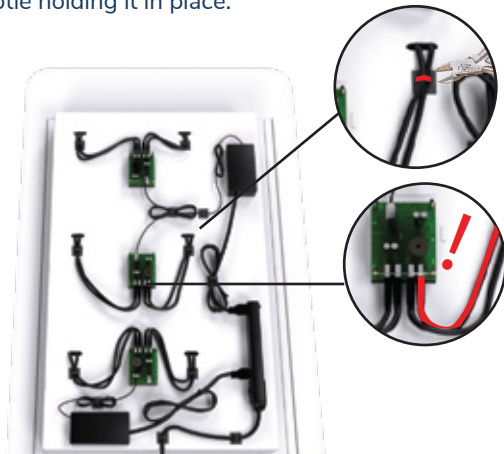

**Assembly Continued:**

- 3** Once zip tie is removed feed the cable through the hole and disconnect it from the charging board. (do not remove zip tie pad)

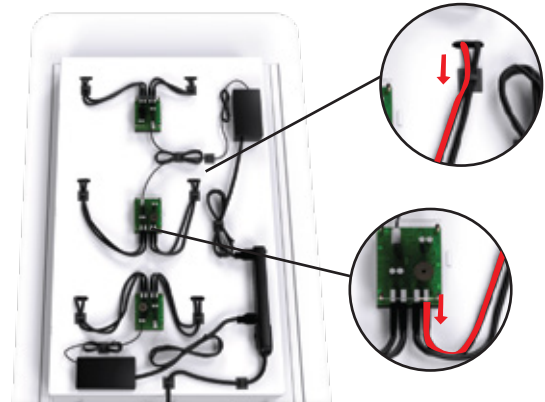

- 4** Using the replacement cables provided swap out the cables. Your locker could have various charging boards a 4 port charging board has a specific order as seen below. An 8 port charging board has no specific order



- 5** Once new cables are confirmed reverse the installation process, step 2 (rezip tie to pad), step 1 (mount back into place). Again make sure have 2 people help and feed the power cable back through the opening.

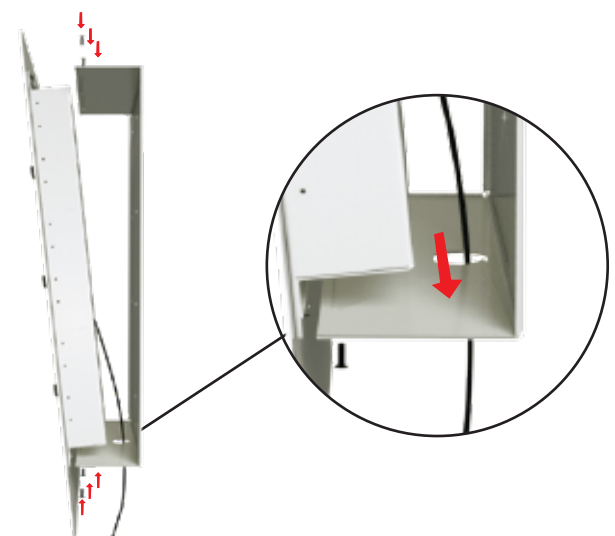

Need more info?